

# 1 BEDROOM TYPE A

105  
108

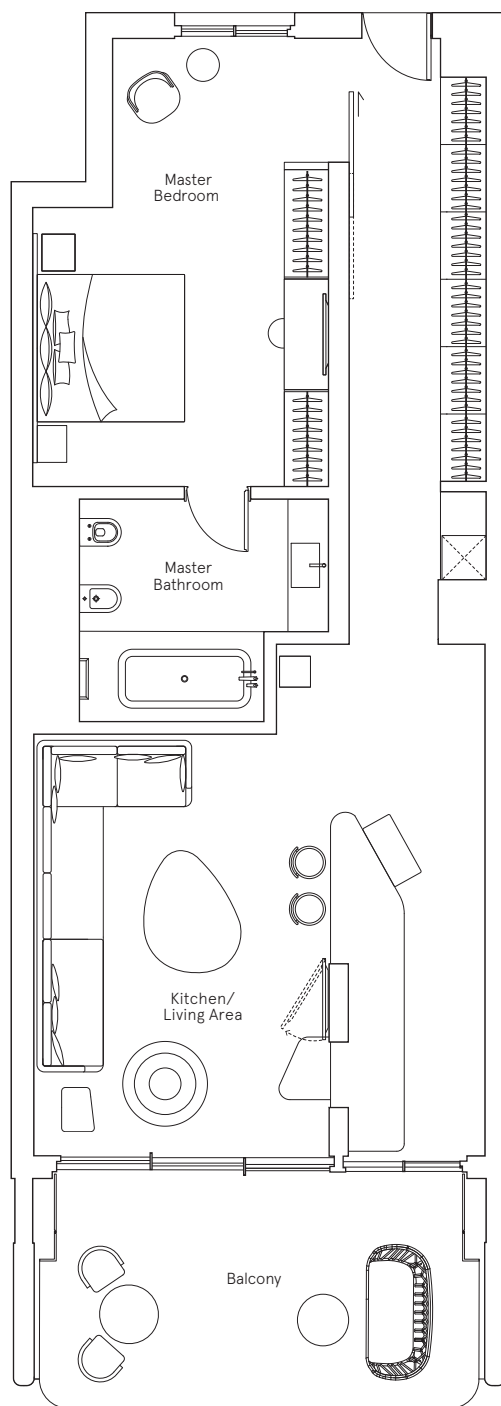

Sea view

<b>Kitchen/Living Area</b>	6.90m x 6.10m	19'9" x 20'1"
<b>Master Bedroom</b>	6.00m x 4.00m	19'8" x 13'1"
<b>Balcony</b>	17.95 sq m	193 sq ft
<b>TOTAL</b>	<b>84.50 sq m</b>	<b>910 sq ft</b>

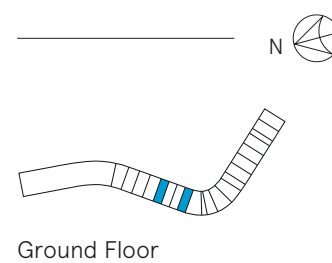

# 1 BEDROOM TYPE B

106  
107  
113

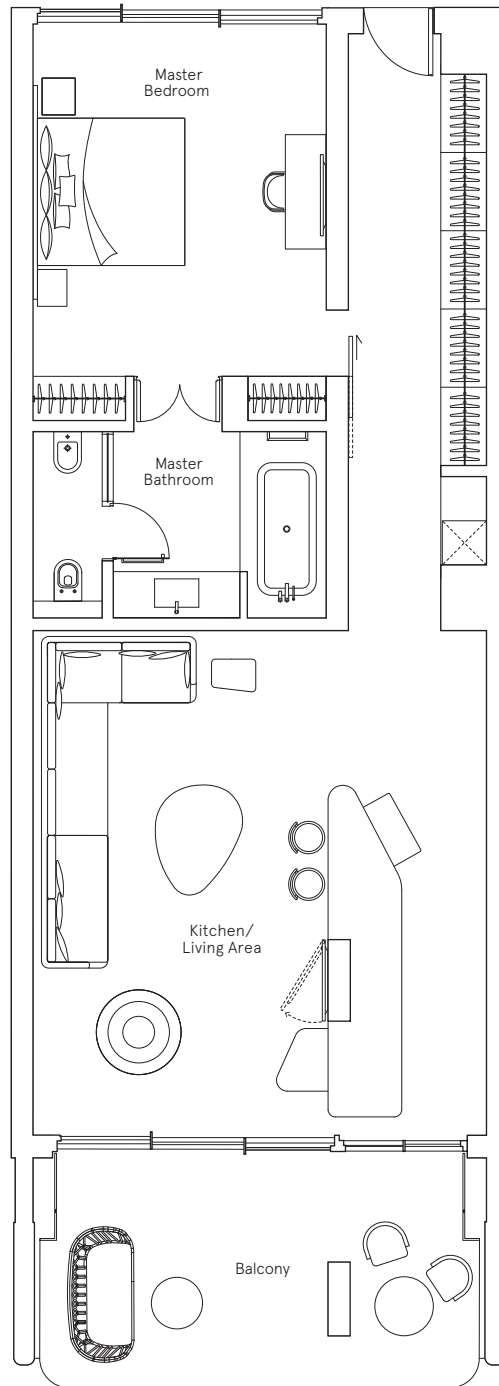

Sea view

<b>Kitchen/Living Area</b>	6.85m x 6.15m	22'6" x 20'2"
<b>Master Bedroom</b>	5.35m x 4.00m	17'7" x 13'1"
<b>Balcony</b>	18.30 sq m	197 sq ft
<b>TOTAL</b>	<b>87.50 sq m</b>	<b>942 sq ft</b>

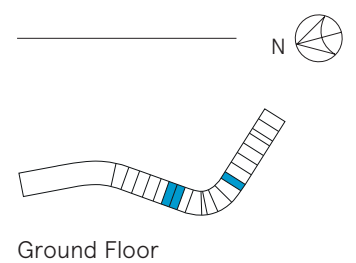

## W Residences Algarve

Estrada da Galé Sesmarias  
Caixa Postal nº 290-H  
8200-385 Albufeira  
Portugal

walgarveresidences.com  
sales@walgarveresidences.com  
+44 (0)20 7016 3740

Local Sales Office  
+351 800 91 93 93

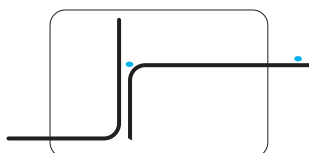

NOZUL ALGARVE S.A.

©2019 Nozul Algarve and Marriott International, Inc. All Rights Reserved. W and its logos are the trademarks of Marriott International, Inc., or its affiliates.

W Residences Algarve are not owned, developed or sold by Marriott International, Inc. or its affiliates ("Marriott"). Nozul Algarve S.A. uses the W marks under a licence from Marriott, which has not confirmed the accuracy of any of the statements or representations made herein. All artist renderings are for illustrative purposes only and are subject to change without notification. All of the services, amenities, benefits and discounts made available to residential owners at W Residences Algarve are as currently scheduled and are subject to change, replacement, modification or discontinuance. Fees may apply.



Designed & produced by Sectorlight (1808236) +44 (0)20 7264 7700 sectorlight.com April 2019.